

Instruction Manual

# Touchpad

STP113



Sandstrøm



## Contents

Unpacking.....	5
Product Overview.....	6
Charging the battery .....	7
Connecting the USB Nano Receiver .....	8
Switching On.....	8
Pairing .....	9
Touchpad Gestures .....	10
Touchpad Gestures - Windows 8 Shortcuts .....	11
Hints and Tips.....	13
Specification .....	13
Safety Warnings .....	68

## Safety Warnings

### **Wireless Devices:**

Before boarding any aircraft or packing a wireless device in luggage that will be checked in, remove the batteries from the wireless device.

Wireless devices can transmit radio frequency (RF) energy, whenever batteries are installed and the wireless device is turned on (If it has an On/Off switch).

### **Battery-Powered Devices:**

Improper use of batteries may result in battery fluid leakage, overheating, or explosion.

Released battery fluid is corrosive and may be toxic. It can cause skin and eye burns, and is harmful if swallowed.

- Don't disassemble the unit or remove any parts.
- Don't immerse the unit in water or any liquid.
- Don't use the unit close to heat sources or expose to high temperatures.
- Don't use the unit where strong electromagnetic waves are present. Strong electromagnetic waves will cause damage to the unit.
- Keep the unit away from direct sunlight, moisture, dirt or abrasive chemical products (cleaning products etc).

## Unpacking

Remove all packaging from the unit. Retain the packaging. If you dispose of it please do so according to local regulations.

The following items are included:

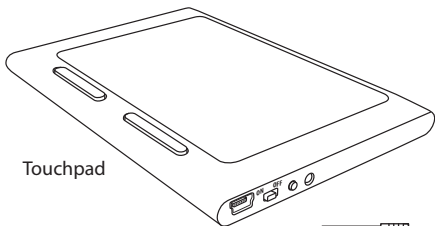

Touchpad



Nano Receiver

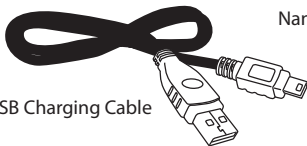

USB Charging Cable



If items are missing, or damaged please contact Partmaster (UK only). Tel: 0844 800 3456 for assistance.

## Product Overview

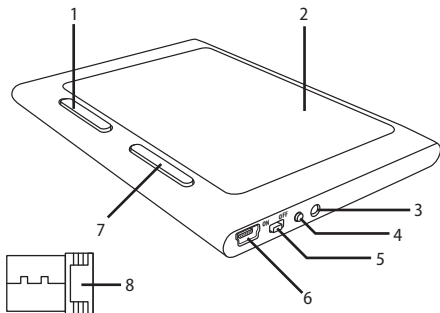

- |  |                     |
|--|---------------------|
| 1. Left Mouse Button   | 4. Pairing Button   |
| 2. Touchpad  | 5. On/Off Switch    |
| 3. Pairing/Charging light<br>• Green when charging<br>• Flashes Red when pairing | 6. Micro USB Socket |
| 7. Right Mouse Button  | 8. Nano Receiver    |

## System Requirements

1. OS : Windows® Xp / Vista® / 7® / 8®
2. Computer : PC Pentium 233 or above
3. USB : 2.0

## Charging the Battery

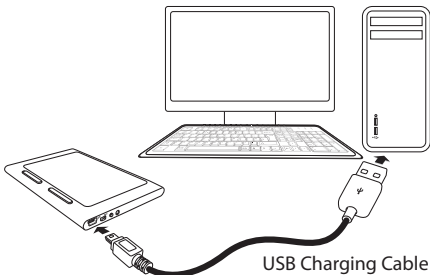

1. Use the USB Charging Cable to connect the Touchpad to your computer.
2. The Green indicator light will come on to show it's charging. When the battery is fully charged the green indicator light will switch off. The battery should take approximately 3 hours to fully charge.



- Attention should be given to the environmental aspects of battery disposal.
- Batteries (battery pack or batteries installed) must not be exposed to excessive heat such as sunshine, fire or the like.

## Connecting the Nano Receiver

- Insert the nano receiver into a USB port on your computer.

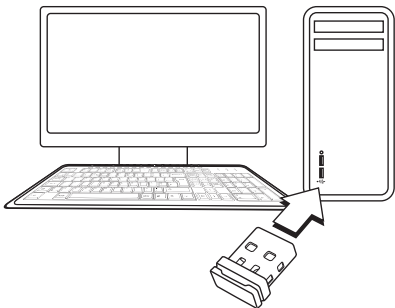

## Switching On

- Switch the ON/OFF switch to ON. The red light will briefly light up then switch off.

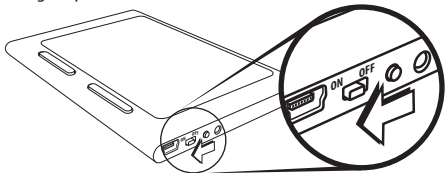

## Pairing

The trackpad should automatically pair with your computer. If it doesn't pair automatically follow the instruction below.

1. With the trackpad switched on press the PAIRING button.  
The red pairing light will flash for 10 seconds, it stops flashing when the trackpad is paired.

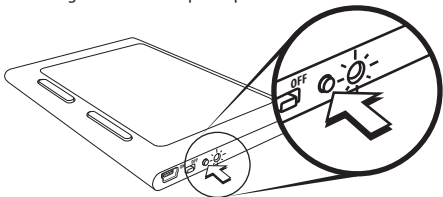

If the red light keeps flashing move the track pad closer to the receiver, switch it off, then back on and repeat the process above.

## Touchpad Gestures

To scroll up and down and left and right use two fingers as shown below.

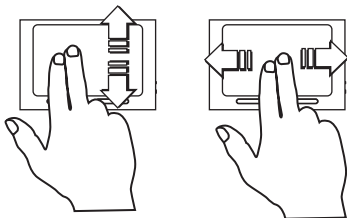

To make a selection tap the touchpad with one finger



To zoom out of a window pinch your thumb and forefinger together or to zoom in open them apart.

### Zoom Out



### Zoom In

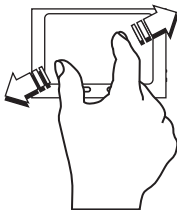

The touchpad gestures may not work with all applications, this is not a fault of the touchpad.

## Touchpad Gestures - Windows 8 Shortcuts

Use one finger to swipe from the left edge to cycle through your open apps.

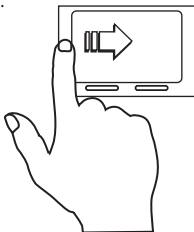

Use one finger to swipe from the right edge to display the Charms Bar.

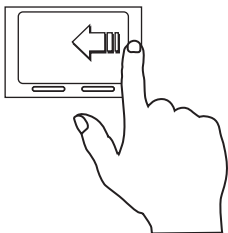

Use one finger to swipe from the top edge to display the Application Bar.

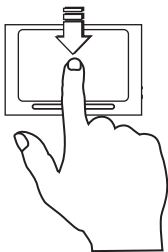

## Hints and Tips

Touchpad is not working	<ul style="list-style-type: none"><li>• Switch the Touchpad OFF and ON.</li><li>• Check the Nano Receiver is connected.</li><li>• Change the USB port used for the Nano Receiver. Connect it directly into your computer if you are using a USB hub.</li><li>• Remove any objects that are between the Touchpad and Nano Receiver.</li></ul>
Pairing/ Charging light is red	<ul style="list-style-type: none"><li>• The battery needs charging. Charge the battery.</li><li>• The Touchpad is in pairing mode.</li></ul>
Pairing/ Charging light is green	<ul style="list-style-type: none"><li>• The battery is charging.</li></ul>

## Specification

<b>Model Number</b>	STP113
<b>Dimensions (L x W x H)</b>	138 x 89 x 10 mm
<b>Battery Type</b>	Built -in, Rechargeable Li Polymer Battery, 380mAh
<b>Wireless Connection</b>	RF 2.4Ghz





This symbol on the product or in the instructions means that your electrical and electronic equipment should be disposed at the end of its life separately from your household waste. There are separate collection systems for recycling in the EU.

For more information, please contact the local authority or your retailer where you purchased the product.

Features and specifications are subject to change without prior notice.

Windows is a registered trademark of Microsoft Corporation in the United States and other countries.

DSG International Sourcing declares that the wireless touchpad comply with the essential requirements and other relevant provisions of Directive 1999/5/EC.

DSG Retail Ltd. (co. no. 504877)  
Maylands Avenue, Hemel Hempstead, Hertfordshire, HP2 7TG, UK

IB-STP113-130402V2