

LOGIK

Wireless Mouse

Instruction Manual

L135BUN20 / L144BUN20 / L155BUN20



Contents

Product Overview	4
Unpacking	5
Installing the Batteries	6
Connecting the Nano Dongle	6
Activating the Wireless Mouse	7
Energy Saving	7
Hints and Tips.....	8
Specifications.....	9

Safety Warnings

Wireless Mouse

Read all the instructions carefully before using the unit and keep them for future reference. Retain the manual. If you pass the unit onto a third party, make sure to include this manual.

Optical:



Never point the optical sensor towards the face, particularly the eyes, to avoid possible injury.



While the mouse is in use, the optical light is visible to the naked eye. Avoid looking directly into the emitter hole while the mouse is active.

Wireless Devices:

- Before boarding any aircraft or packing a wireless device in luggage that will be checked in, remove the batteries from the wireless device.
- Wireless devices can transmit radio frequency (RF) energy, whenever batteries are installed and the wireless device is turned on (If it has an On/Off switch).

Battery-Powered Devices:

- Improper use of batteries may result in battery fluid leakage, overheating, or explosion.
- Released battery fluid is corrosive and may be toxic. It can cause skin and eye burns, and is harmful if swallowed.

To Reduce the Risk of Injury:

- Keep batteries out of the reach of children.
- Do not heat, open, puncture, mutilate, or dispose of batteries in fire.
- Do not mix new and old batteries or batteries of different types.
- Do not allow metal objects to touch the battery terminals on the device; they can become hot and cause burns.



This unit is designed for indoor use only.



This equipment is a Class II or double insulated electrical appliance. It has been designed in such a way that it does not require a safety connection to electrical earth.



AC voltage: This symbol indicates that the rated voltage marked with the symbol is AC voltage.



DC voltage: This symbol indicates that the rated voltage marked with the symbol is DC voltage.



The symbol on the product or its packaging indicates that this product must not be disposed of with your other household

waste. Instead, it is your responsibility to dispose of your waste equipment by handing it over to a designated collection point for the recycling of waste electrical and electronic equipment. The separate collection and recycling of your waste equipment at the time of disposal will help conserve natural resources and ensure that it is recycled in a manner that protects human health and the environment. For more information about where you can drop off your waste for recycling, please contact your local authority, or where you purchased your product.



Notes for battery disposal

The batteries used with this product contain chemicals that are

harmful to the environment. To preserve our environment, dispose of used batteries according to your local laws or regulations. Do not dispose of batteries with normal household waste. For more information, please contact the local authority or your retailer where you purchased the product.

Currys.co.uk

All the support you need.

Whether it's a tech emergency or you need plain good advice, we're always on hand to help.

UK: 0344 561 1234

IRE: 0818 810575

Partmaster
CO.UK

Visit Partmaster.co.uk today for the easiest way to buy electrical spares and accessories. With over 1 million spares and accessories available we can deliver direct to your door the very next day. Visit www.partmaster.co.uk or call **0344 800 3456** (UK customers only). Calls charged at National Rate.

Currys Group Limited (co. no. 504877)
1 Portal Way, London, W3 6RS, UK

<https://www.currys.co.uk>

Contact Details: business.standards@currys.co.uk

EU Representative

Currys Ireland Limited (259460)
3rd Floor Office Suite,
Omni Park SC, Santry, Dublin 9,
Republic of Ireland

<https://www.currys.ie>

Responsible person: Currys Ireland Limited

Contact details: business.standards@currys.co.uk

Safety-Mouse-UK-241127V7

Product Overview

Top View

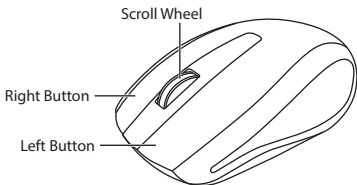

Bottom View

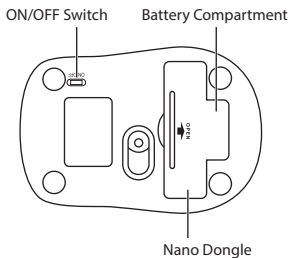

Thank you for purchasing your new product.

We recommend that you spend some time reading this instruction manual in order that you fully understand all the operational features it offers. You will also find some hints and tips to help you resolve any issues.

Read all the safety instructions carefully before use and keep this instruction manual for future reference.

Unpacking

Remove all items from the packaging. Retain the packaging. If you dispose of it please do so according to local regulations.

The following items are included:

- Main Unit (with nano dongle)
- AAA Size Battery x 2
- Instruction Manual

Installing the Batteries

Change the battery if the mouse no longer reacts to input.

1. Lift the battery cover up.
2. Insert 2 x AAA batteries.
3. Close the battery cover.

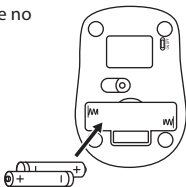

Please ensure the batteries' polarities (+/-) match the battery compartment's polarities.

Connecting the Nano Dongle

Remove the Nano Dongle from the mouse and then plug the Nano Dongle directly into your computer's USB port.



Nano Dongle

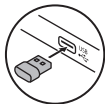

Activating the Wireless Mouse

Switch the **ON/OFF** button to power on the mouse and then the mouse will automatically connect to the Nano Dongle plugged into your computer.

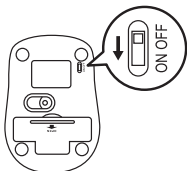

Energy Saving

If the mouse is not activated for approx. 3 seconds, it switches to energy saving mode with a current flow of up to 0.3 mA. After 10 minutes of no activity, the LED switches off and the current flow drops to 0.03 mA. To wake up the mouse, press any button.



- If the mouse does not use for a long period, switch the **ON/OFF** switch into the **OFF** position to conserve energy.
- The mouse switches off if a transmission signal is no longer received. If necessary, remove the nano dongle and insert it in the dongle dock on the bottom of the mouse as the dongle is very small and can be easily lost.

Hints and Tips

Mouse not working:

1. Check that the power switch is in the **ON** position.
2. Check battery installation. Replace battery if needed.
3. Repeat the connection procedure. You can also try moving the mouse closer to the Nano Dongle.
4. If the mouse is moving erratically, change the working surface which the mouse is operating on.
5. Make sure the Nano Dongle is plugged into a USB port and the computer is on or try the Nano Dongle in a different USB port.
6. If mouse performance is slow or intermittent around a wireless network, unplug the Nano Dongle from the USB port and then reinsert it. To reactivate the mouse, switch it on, off and on again using the **ON/OFF** switch on the bottom of the mouse.

Specifications

Model	L13SBUN20 L14BUN20 L15BUN20
Operating Systems	Microsoft® Windows® 7 / 8 / 10
Operating Range	6m (10m in open space)
Resolution	1000 dpi
Frequency Band(s)	2403 – 2477 MHz
Max. Radio Frequency Power Transmitted	Mouse: 0 dBm Dongle: 4 dBm
Dimension (L x W x H)	100.5 x 61.0 x 35.5 mm
Net Weight	56 g

Features and specifications are subject to change without prior notice.

**Declaration of Conformity (RER)**

Hereby, Currys Group Limited declares that the radio equipment type [L13SBUN20 / L14BUN20 / L15BUN20] is in compliance with Radio Equipment Regulations 2017 (S.I. 2017/1206).

The full text of the UK declaration of conformity is available at the following internet address:

<https://www.currys.co.uk/>

Click on **HELP & SERVICES/Repairs & maintenance/Product Manuals** and enter the model number.

Windows 7, Windows 8 and Windows 10 are either trademarks or registered trademarks of Microsoft Corporation in the United States and/or other countries.

All trademarks are the property of their respective owners and all rights are acknowledged.

