

KENWOOD

8KG washing machine K814WM18 / K814WMT18

installation / instructions manual



Contents

safety warnings	5
unpacking.....	8
moving and installing.....	9
removing the transit bolts	9
moving the washing machine from one location to another	9
installing your washing machine	10
choosing the right location for your washing machine.....	10
hose and cable lengths	11
levelling the washing machine.....	11
water supply hose	11
connecting to the mains supply	12
first time use	12
product overview.....	13
the unit.....	13
the control panel.....	14
preparation.....	15
organising laundry	15
preparing laundry	15
important information	16
washing delicates (wool and silk)	16
adding delicate laundry items to the drum.....	16
which detergent to use	16
adding detergent and softener	17
selecting the programme	18
wash setting.....	20
first washing operation	20
standard washing	20
manual soaking	21
half-load detection system.....	21
optional functions	21
washing water temperature selection.....	21
spin speed.....	21
delay timer.....	22
how to set the child lock	22
selecting a prewash.....	22
removing laundry.....	22
maintenance - cleaning the washing machine	23
cleaning the drum.....	23
cleaning the exterior of your washing machine	23
cleaning the detergent drawer and siphon plug	23
cleaning the door seal and window	23
cleaning the drain filter	24
cleaning the filter net of the water supply hose	24
troubleshooting	25
error codes.....	27
product fiche.....	28

energy label.....	29
specifications.....	29

safety warnings

For your continued safety and to reduce the risk of injury or electric shock, please follow all the safety precautions listed below.

WARNING!

- If you will not be using the washing machine for a while such as when you go on holiday, disconnect the plug from the mains supply and turn off the water supply to the washing machine. This is particularly important if there is no drainage around the washing machine.
- If the water supply is left on, water pressure may build up and cause a leak.

General Use

- Transit bolts are used to transport the washing machine. You should remove these using a spanner or similar tool before you install the washing machine. If you do not, it will cause strong vibrations when the washing machine is spinning.
- Do not install your washing machine anywhere that is damp or exposed to the weather. If you do, it may cause an electric shock, fire, failure or deterioration.
- Do not pour water directly onto any part of the washing machine. It may cause a short circuit or electric shock.
- Keep burning objects such as candles or cigarettes, away from the washing machine. They may cause a fire or damage.
- Keep flammable substances well away from the washing machine – for example kerosene, gasoline, benzene, paint thinner and alcohol, or clothing soaked with these. They may cause an explosion or a fire.
- This washing machine is only suitable for washing textiles labelled 'washing machine washable'.
- Do not connect the washing machine to hot water. The washing machine works with cold water supply only.
- Before you start using the washing machine, turn the tap on to check that the hose is properly connected. If it's not, there may be a water leak.
- Do not put too much laundry or detergent into the washing machine. It may cause issues with the washing machine or laundry.
- Be careful not to get your laundry caught in the door when you close it. This could cause a water leak or damage your laundry.
- This washing machine is for household (domestic) use only.

Power Source and Cable

- Use an independent household dedicated mains socket, rated at 13 Amp 220V to 240V AC. If the washing machine is plugged in with other appliances, it may overheat and cause a fire.
- Make sure the mains plug is pushed firmly into the socket. A loose connection may overheat and cause electrical shock or a fire.
- Check the mains lead and mains plug for any damage. If the mains cable is damaged, it must be replaced by the manufacturer, its service agent or similarly qualified persons in order to avoid a hazard.
- Unplug the mains lead when cleaning the washing machine.
- Do not touch the mains lead or mains plug with wet hands. It may cause an electric shock.
- Check the mains plug regularly for dirt. If dirt accumulates on the mains plug, it could cause a fire. To prevent this, unplug the cable and clean the mains plug with a dry rag.
- If you disconnect the mains plug, hold onto the mains plug not the cable. Pulling the cable may cause an electric shock or a fire.
- Do not use a mains plug adapter or extension cable. It may overheat and cause a fire.
- Make sure your home voltage matches the voltage displayed on the washing machine. If you are not sure, contact an electrician.
- The mains plug must remain accessible to allow disconnection or an all pole switch must be incorporated in the fixed wiring in accordance with the wiring regulations.

To Prevent Injury / Damage

- Do not climb on the washing machine. You may hurt yourself or damage the washing machine.
- When opening and closing the door ensure you keep fingers away from the door hinge, or this could lead to injury.
- Check your washing for objects such as nails, pins, coins, clips etc. They could damage your laundry or the washing machine.
- To prevent any large, heavy objects (e.g., buckles, large buttons, etc.) from hitting the glass door, turn your clothing inside out or remove the heavy objects. They could damage your laundry or the washing machine.
- Do not wash, rinse or spin water-proof sheets or clothing. These may cause vibration or washing machine failure during spin-drying, which could lead to injury, damage to the washing machine or damage due to water leaking.
- Be careful when draining hot water or any detergent from the drum.

- Do not dismantle, repair or modify the washing machine. The washing machine could malfunction and cause a fire or injury.
- This appliance can be used by children aged from 8 years and above and persons with reduced physical, sensory or mental capabilities or lack of experience and knowledge if they have been given supervision or instruction concerning use of the appliance in a safe way and understand the hazards involved. Children shall not play with the appliance. Cleaning and user maintenance shall not be made by children unless they are older than 8 and supervised.
- Children should be supervised to ensure that they do not play with the appliance.
- Children of less than 3 years should be kept away unless continuously supervised.
- Do not touch the laundry inside the washing machine, until the drum has completely stopped. Even if the drum is spinning at low speed it can cause an injury. Take particular care of children in this respect.
- The appliance is to be connected to the water mains using the new hose-set supplied. Old hose-sets should not be reused.
- The ventilation openings in the base of the washing machine must not be obstructed by a carpet.

WARNING



IT IS HAZARDOUS FOR ANYONE OTHER THAN AUTHORISED SERVICE PERSONNEL TO CARRY OUT SERVICING OF REPAIRS WHICH INVOLVE THE REMOVAL OF COVERS.



TO AVOID THE RISK OF AN ELECTRICAL SHOCK DO NOT ATTEMPT REPAIRS YOURSELF.

Thank you for purchasing your new Kenwood Washing Machine.

These operating instructions will help you use it properly and safely.

We recommend that you spend some time reading this installation/instruction manual in order that you fully understand all the operational features it offers.

Read all the safety instructions carefully before use and keep this installation/instruction manual for future reference.

unpacking

Remove all items from the packaging. Retain the packaging. If you dispose of it please do so according to local regulations.

The following items are included:

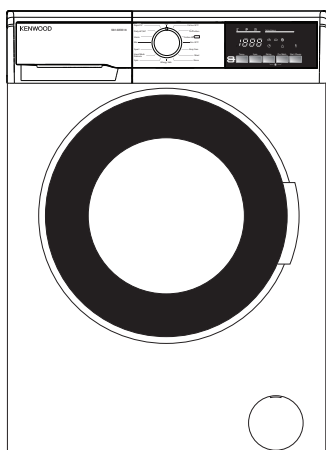

Main Unit

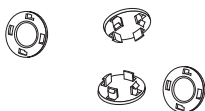

Transport Bolt Covers x 4

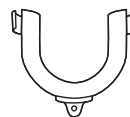

U-Shape Drain Hose Holder



Water Supply Hose x 1

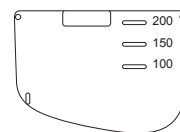

Liquid detergent guide x1



If items are missing or damaged please contact Partmaster (UK only).
Tel: 0344 800 3456 for assistance.

installation

moving and installing

removing the transit bolts

Four transit bolts keep the interior of the washing machine in place while it's being moved. They need to be removed before installation. Use a spanner (not supplied) and follow the instructions detailed below.



Don't run the washing machine without removing the transit bolts, as this can cause excessive vibrations and may damage your machine.

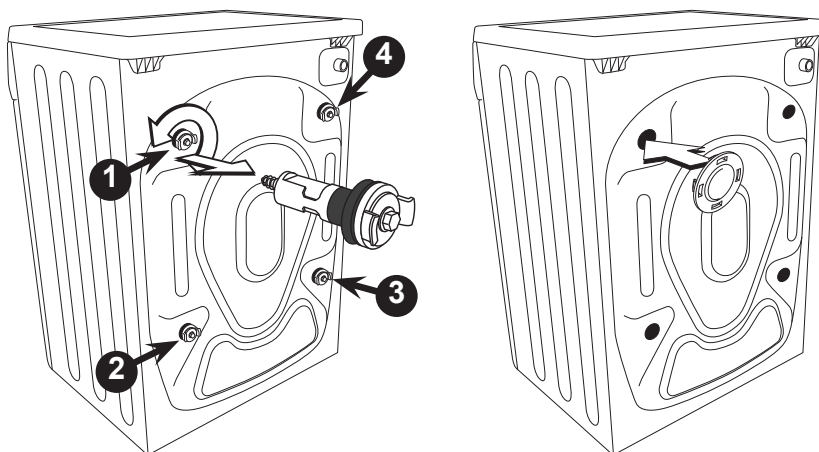

Keep the four (4) transit bolts in a safe place, in case you need to move the washing machine.

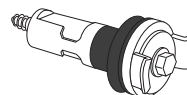

to remove the transit bolts:

1. Ensure the unit is fully disconnected from the mains power by unplugging it from the mains.
2. Unscrew the four (4) transit bolts.
3. They are located at the rear side of the washing machine. Use a spanner (not included) to loosen the four (4) transit bolts, then pull out the bolts horizontally. Ensure the plastic bolt guides (if any) are also removed.
4. Snap in the plastic caps to cover the transit bolt holes.

moving the washing machine from one location to another

Before you move the washing machine:

- Shut off the tap and run the washing machine to drain the water. Drain any remaining water from the pump hose.
- Disconnect the mains cable.
- Attach the transit bolts.



Make sure to fix the transit bolts prior to moving the washing machine.

installation

installing your washing machine

Please Read And Follow The Instructions Carefully.

- In addition to the instructions mentioned here, special regulations of the relevant water and power supply companies may apply. If in doubt, have the washing machine connected by a qualified technician.
- The washing machine is heavy - caution when lifting it. Do not lift by projecting components (e.g. washing machine door).
- Warning: Frozen hoses may tear/burst. Do not install washing machine in outdoor areas or where there is a risk of frost.
- Lay hoses and cables in such a way that there is no risk of tripping over them.



An additional space (approximately 60mm) is required at the rear of the washing machine. This is to allow enough space for the water hose and drain hose connections.

choosing the right location for your washing machine

- Make sure there's enough space for your washing machine.
- Install your washing machine on a flat, stable surface to avoid excessive vibrations and noise.
- Don't install your washing machine in direct sunlight or in a place where temperatures can reach freezing.

x Sloping surface

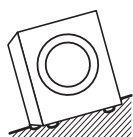

x Unstable



x Bumpy surface

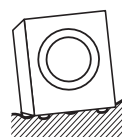

Two or more people are required to move the washing machine.

- The ventilation openings in the base of the washing machine must not be obstructed by carpet.
- Start by tilting the washing machine backwards.
- One person should stand behind it, holding the rear of the top panel. The other person should grip the bottom feet at the front.
- Check that you have all the required accessories for installation.
- We recommend that you entrust the installation of the washing machine to a qualified technician.

installation

hose and cable lengths

How to connect from the left side

How to connect from the right side

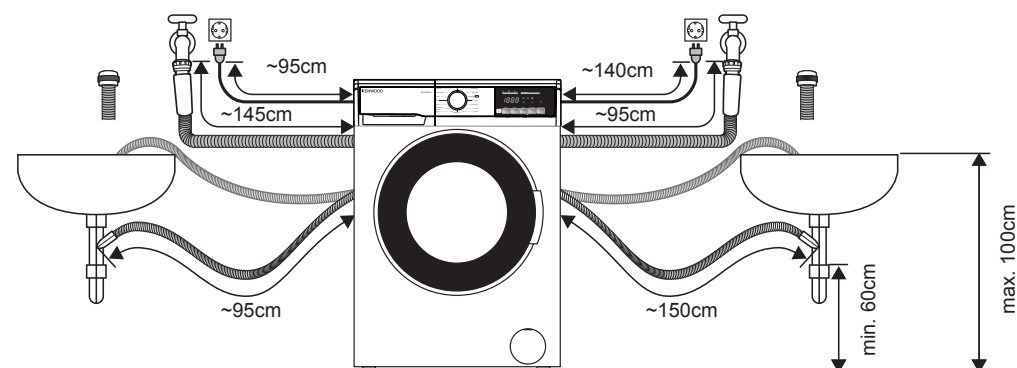

levelling the washing machine

There are 4 levelling feet on the underside. They **MUST** be adjusted to make sure the washing machine is level.

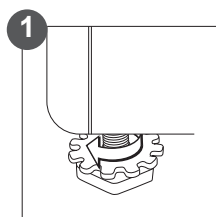

On each foot, loosen the lock ring by turning clockwise.

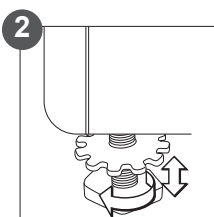

Adjust all four feet by rotating each upwards or downwards.

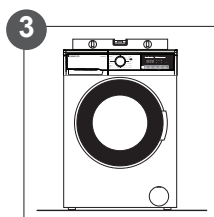

Use a spirit level to ensure the washing machine is level.

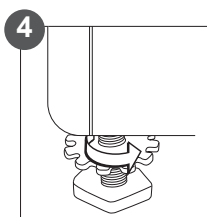

Tighten each lock ring by turning them anti-clockwise (towards the washing machine body).

Ensure all four lock rings are tightened securely. Check the feet are still bolted to the washing machine - if they're unbolted, the washing machine will move around.

water supply hose

Points to remember

- Follow the instructions in this section to avoid water leaks.
- Don't connect the hose to a combination tap.
- Don't twist, squash, modify or cut the hose.
- This machine is designed to connect to the cold water supply. Do not connect to the hot water supply.
- Use only the new water supply hose supplied. Old hose sets should not be reused.
- The mains water pressure must be 0.1MPa - 1MPa.
- If your washing machine is delivered in freezing weather conditions, leave it at room temperature for 24 hours after you've set it up before using it. This ensures there's no ice blocking the water supply hose. If your water supply hose freezes, add 2 or 3 litres of warm water to the drum. Then run a "Spin" only programme.

* All images are for indication only; please refer to your individual unit for actual item.

installation

Connecting the water supply hose

1. To prevent leakage from the connection joints, ensure the rubber washer seals are fitted to each end of the water supply hose. Do not use without the seals in place.
2. Fit the straight end of the water supply hose to the cold water tap.
3. Connect the angled end of the white headed hose to the water inlet valve on the machine. Hand tighten the plastic parts of the connections. If you are unsure, please call a qualified plumber.
4. Open the tap slowly and check that there are no leaks around the connection joints.

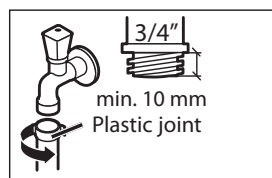
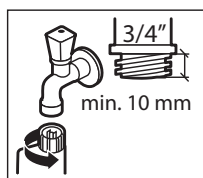

Cold water inlet
(White filter valve)

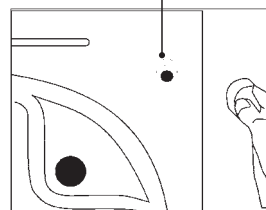

Draining to a sink or wash-basin

- Secure the drain hose in position, so it can't drop out of the basin.
- Don't block the basin's drain outlet, and make sure that the drainage through is sufficient to prevent overflowing.
- Don't let the tip of the drain hose dip into the drained water, as this can cause the water to flow back into the washing machine.

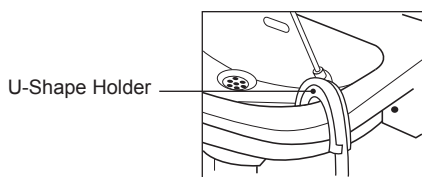

U-Shape Holder

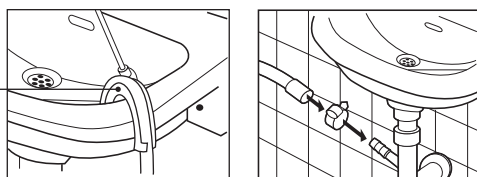

Draining to a wash-basin

Draining to a drain hose



When connecting to the drain ensure the blanking plate has been removed.

connecting to the mains supply

For your safety:

- Do not use a mains plug adapter or extension cable.
- If the mains cable or mains plug are damaged, disconnect from the main, stop using them and call a qualified technician for assistance.
- Mains cord of your washing machine is equipped with an Earthed plug. This plug must always be inserted to an earthed socket capable of supplying 13 Amps. If you don't have such a socket and fuses in your house, please call a qualified electrician.

first time use

Some water may be left in your machine due to tests carried out during production. To dispose of this water, it is recommended to perform the first washing operation with the programme (Cotton 90°C) and without laundry by inserting ½ portion of detergent in the main detergent (II) compartment of the detergent drawer.



During initial start-up and use of the unit, there may be a slight smell while the motor is settling in. This is not a fault; this is normal operation.

* All images are for indication only; please refer to your individual unit for actual item.

product overview

the unit

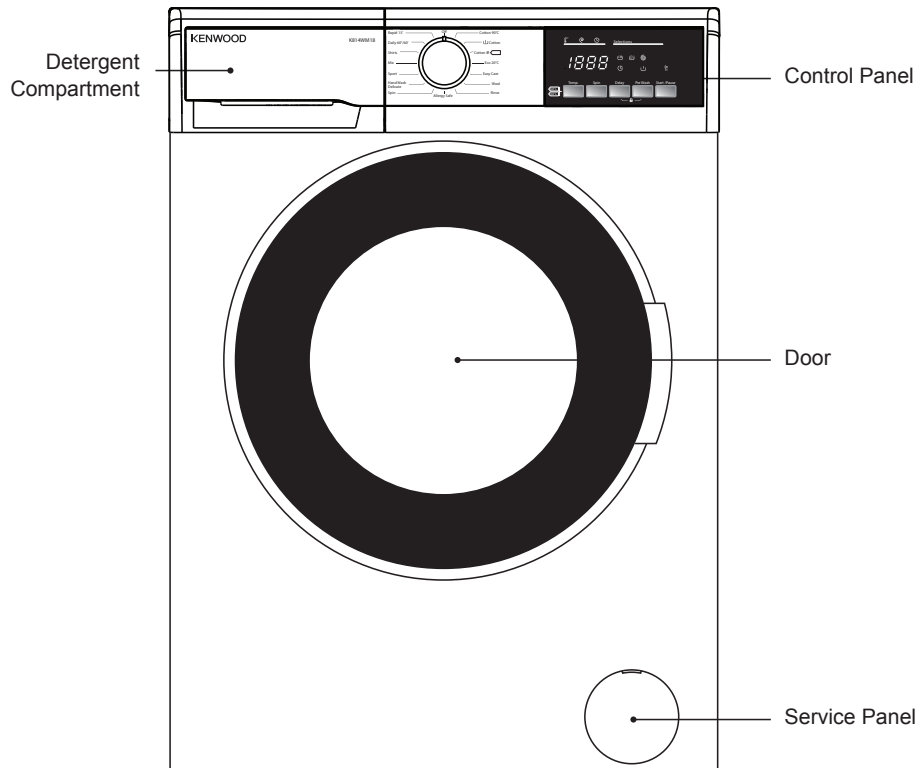

the control panel

Programme Dial

Different wash programmes can be selected according to your wash requirements.

LED Display

- The delay icon will be on to indicate the delay time.
- After the wash procedure begins, the display will show the wash remaining time, spin speed and other function options.
- When the child lock function is selected, the Child Lock icon will be illuminated.
- When the door is at the lock state, the Door Lock icon will be illuminated.

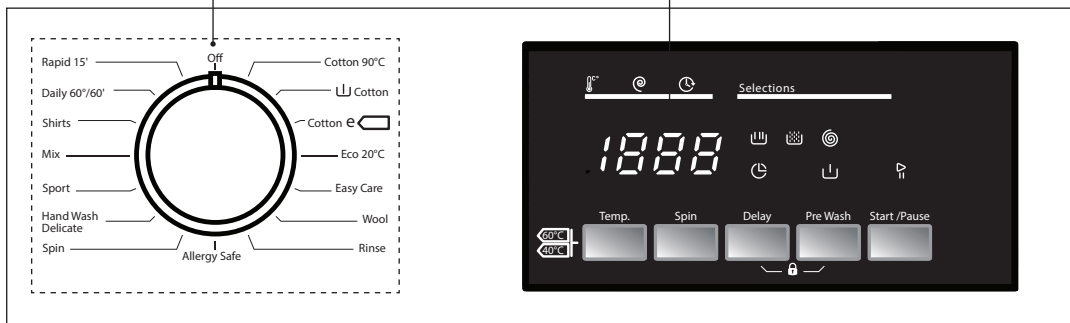

Button	Function
Temp	Press continuously to select the desired temperature of the selected wash programme. You can only select a temperature lower than the selected programmes temperature. 90°C - 60°C - 40°C - 30°C or - - (cold)
Spin	Press continuously to select the desired spin speed of the selected wash programme. 1400 - 1200 - 800 - 600 - 400 - OFF (- -)
Delay	This button is used to delay the wash. Press continuously to select the time you want to start the wash. You can set a delay time of up to 23 hour.
Pre Wash	Press this button to get an extra wash before main wash.
Child Lock	Press and hold the Delay and Pre Wash buttons at the same time until you see 'CL' in the display to activate the child lock.
Start/Pause	Press to start your wash. Press while in operation to pause your wash.



If you want to cancel any programme running:

- Switch the programme knob to **OFF** position.
- Your machine will stop the washing operation and the programme will be cancelled. (Ensure the Child Lock is off, otherwise the original programme will continue.)
- To empty the water accumulated in the machine switch the programme knob to any programme.
- Your machine will perform the necessary discharge operation and cancel the programme.
- You can then select a new programme.



During initial start-up and use of the unit, there may be a slight smell while the motor is settling in. This is not a fault; this is normal operation.

preparation

Read the following to understand how best to prepare your laundry for washing.

organising laundry

- Read the washing label on each garment to help you sort your washing into different loads.
- Sort the laundry by colour, type of fabric and by how soiled it is. This will help you choose the correct programme and temperature for each wash.
- Do not exceed the maximum load!

Fibre Type	Maximum Loading Capacity
Cotton	8.0kg
Synthetic	3.5kg
Wool	2.5kg
Delicate	3.5kg

preparing laundry

- Treat stains before washing.
- Some items should be put into a cleaning net before going into the washing machine, i.e. bras with metal wires, tights and lace clothing to prevent damage.
- Check that pockets do not contain any objects which may damage your clothes and the washing machine.
- Tie up any loose strings on laundry, close zippers and reverse clothing with zips inside out.
- To prevent any large, heavy objects (e.g., buckles, large buttons, etc.) from hitting the glass door, turn your clothing inside out, or remove the heavy objects. These could damage your laundry or the washing machine.
- Remove any surplus hair, animal fur, sand, and other materials with a brush before washing.
- If clothes have raised fabric turn them inside out.
- Clothes that are not colour fast should be washed separately.
- Insert your clothes into the washing machine. Close the washing machine door. Ensure that you do not trap any items of clothing between the loading door and the rubber seal.

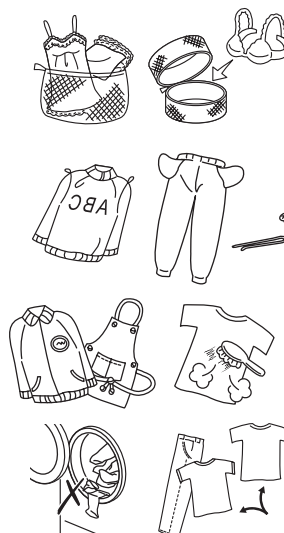

important information

washing delicates (wool and silk)

- Silk laundry loads: 2kg or less
- Approximate Weights:
 - Wool sweater (400g)
 - Silk blouse / under garment (200g)
 - Trousers (400g)

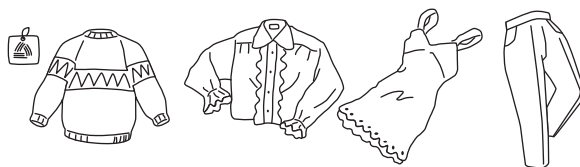

adding delicate laundry items to the drum

- Close zips and buttons.
- Add items one by one on top of each other.
- Don't overload the drum as it may cause excessive vibrations or damage the washing machine.

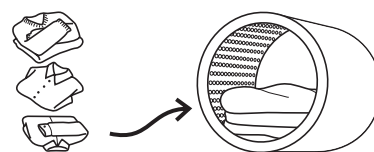

which detergent to use

- For woolen items, use a mild liquid detergent. Other detergents may damage your woolen clothes.
- With wool or silk, you may need to use an extra rinse cycle to remove excess detergent from your clothes. This depends on the amount of detergent you use, and the amount of foam that develops in the main wash cycle.

Washing and type of textile	Washing temperature	Detergent
Boil washable white washing made of linen or cotton	30°C - 90°C (Max)	Standard detergent containing bleach and optical brighteners
Coloured washing made of linen or cotton	30°C - 60°C (Max)	Colour detergent without bleach and optical brighteners
Coloured washing made of easy-care fibres, synthetic materials	30°C - 60°C (Max)	Colour/mild detergent without optical brighteners
Delicate fine textiles, silk or viscose	30°C - 40°C (Max)	Mild detergent
Wool	30°C - 40°C (Max)	Detergent for woollens

adding detergent and softener

- Add detergent into the appropriate dispenser.
- Apply softener before you start washing.
- Apply detergent and softener according to the washing amount, the soiling level, the water hardness in your area and the manufacturer's instructions of these products.
- For slightly dirty clothes, put a small amount of detergent in compartment (II) of the detergent drawer.
- For excessively dirty clothes, put $\frac{1}{4}$ of the detergent to be used in compartment (I) of the detergent drawer and the remaining amount in compartment (II).

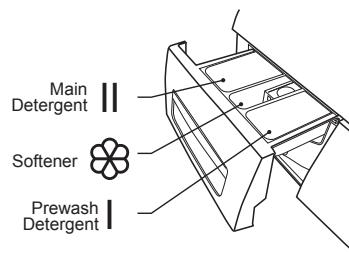



Dilute viscous fabric softener and fabric conditioner with water. Prevent blockage of the overflow.

- Do not use the washing machine when the detergent drawer is removed. It may cause water leak or it may not work normally.
- If you forget to add detergent, you can drain the washing machine by running a drain only programme. Then you can add detergent and start the programme again. Detergent only reaches the drum when water flushes through the detergent drawer.
- To prevent powder detergent staying in the drawer, dry the inside of the drawer with a cloth. Make sure the powder isn't lumpy when you add it into the drawer.
- If the rinse cycle isn't removing all the detergent from your wash, use less detergent.
- Softener should not exceed the MAX level in the compartment.
- Wash out unused softener with a splash of water or a damp cloth after the programme has finished.
- You can use liquid detergents in all programmes.

selecting the programme

Here are the available programmes, additional functions and option settings.

Temperature can be selected separately for certain programmes.

Program			Description	 Prewash Function†		Max Temperature	Max Load (kg)	Preset Setting	
								Default Spin (rpm)	Approximate Time (Min)
Cotton	1	90°C	For average soiled cottons, household linens and work / play clothes.	Available	✓	90°C	8.0*	1400	187
	2	 Cotton		Pre set	✓	60°C	8.0*	1400	164
	3	Cotton e		Available	✓	60°C	8.0*	1400	240
	4	Eco 20°C	For less than average soiled cottons, household linens and work / play clothes.	NOT Available	✓	20°C	4.0**	1400	96
	5	Easy Care	Very dirty or synthetic-mixed textiles.	Available	✓	40°C	3.5	1200	110
	6	Wool	For machine washable woollens.	NOT Available	✓	30°C	2.5	600	43
	7	Rinse	Separate rinse procedure	NOT Available	✗	Water temp	8.0	1400	42
	8	Allergy Safe	For baby laundry	Available	✓	60°C	4.0	800	226
	9	Spin	Separate spin procedure	NOT Available	✗	-	8.0	1400	17
	10	Hand Wash Delicate	Laundry recommended for hand wash or sensitive laundry	NOT Available	✓	30°C	2.5	600	90
	11	Sport	Sportswear	Available	✓	30°C	3.5	800	80
	12	Mix	Dirty cotton, synthetics, colour and flax textiles can be washed together.	Available	✓	30°C	3.5	800	81
	13	Shirts	Dirty cotton, synthetics, and synthetic mixed shirts/blouses can be washed together.	Available	✓	60°C	4.0	600	114
	14	Daily 60°/60'	60 minute wash	NOT Available	✓	60°C	4.0	1400	60***
	15	Rapid 15'	15 minute quick wash for lightly soiled laundry	NOT Available	✓	30°C	2.0	800	15

* Maximum of 4kg of towelling material. ** Maximum of 2kg of towelling material. *** If 2kg or less of laundry is inserted the wash time will be reduced to 30 mins.



-
-  Standard washing cycle programs are the Standard 60° C Cotton Program and the Standard 40°C Cotton Program. These cycles are suitable for cleaning naturally-soiled laundry and are the most efficient washing cycles in terms of combined energy and water consumption.
 - For all washing programs, please following the detergent recommendations on the garment label or on the detergent's packaging.
 - Washing times depend on the program type, ambient water temperature and wash load (weight and type).
 - Energy and water consumption will vary according to wash load and type, extra functions, tap water and ambient temperatures.
 - The actual water temperature may differ from the declared cycle temperature.
 - Your washing machine will automatically detect if you have only inserted half a load or less of laundry, it will automatically reduce the washing time, water consumption and energy in some programs.
 - Your washing machine has an Auto Balance feature. Washing times will be longer if the laundry in the drum needs to be balanced.
-

wash setting

first washing operation

Some water may be left in your machine due to tests carried out during production. To dispose of this water, it is recommended to perform the first washing operation with the programme (Cotton 90°C) and without laundry by inserting ½ portion of detergent in 2nd compartment of the detergent drawer.



During initial start-up and use of the unit, there may be a slight smell while the motor is settling in. This is not a fault; this is normal operation.

standard washing

1. Pull the door handle and put the laundry in the drum. Make sure no laundry gets caught in the door.
2. Close the door and turn the Programme Dial to select your wash programme and water temperature.
3. Adjust the temperature (if required). The temperature can not be set higher than the programmes set temperature.
4. Adjust the Spin Speed (if required).
5. Select any Optional Functions.
6. Add detergent into the detergent drawer. The quantity of detergent will depend on the amount of laundry, the degree of soiling and the water hardness. Use the amount of detergent suggested on the packaging of the detergent.

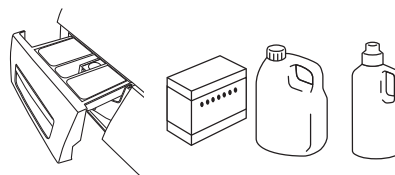
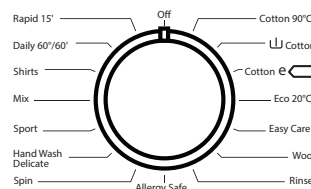

To pause the programme you have selected, press the **Start / Pause** button. The Start/Pause symbol will blink when the machine is in pause mode.



7. Press the **Start / Pause** button to start the washing.
8. The washing machines End LED will light when the programme is complete.



- If the door is locked and you switched the washing machine off - or if there's a power cut - it will stay locked for 2 minutes.
- If the machine is full of water, do not open the door.

manual soaking

To manually soak your laundry, press the **Start / Pause** button a few minutes after the wash programme has started when the drum is full of water. The washing machine will suspend the laundry to soak it in the water. After your desired soaking time, press the **Start / Pause** button, the machine will continue the previous wash.

half-load detection system

Your machine features a half-load detection system. In case you load machine to approximately half or less than the maximum laundry capacity, your machine will run so as to save washing time, water consumption and energy in some programmes. When half load function is active, the machine can complete the programme you have set in a shorter time.

optional functions

Depending on the programme you select, you can combine different optional functions.

- Press the button of the optional function you would like to select.
- If the indication of the function button remains lit it means that the function has been selected.
- If the indication of the function button is flashing it means you cannot use that additional function for the wash programme you selected.

Reason for non-activation:

- The optional function you want to use in the washing programme you have selected is not applicable.
- Your machine has passed the stage, during which the optional function you want to select would be implemented.
- It is not compatible with an optional function you have selected previously.

washing water temperature selection

You can select the washing water temperature with the Temp button.

You can gradually decrease the washing water temperature between the maximum temperature of the selected programme and cold washing by repeatedly pressing the **Temp** button.

If you have missed the washing water temperature you want, continue and the temperature selection will loop back around.

Temperature Cycle

90° - 80° - 70° - 60° - 50° - 40° - 30° - and -- (cold)



spin speed

You can adjust the spin speed by pressing the **Spin** button. Only a lower spin speed than the one of the selected program can be selected.

Spin speeds selectable are:

1400 - 1200 - 1000 - 800 - 600 - 400 - or -- (no spin)



delay timer

You can set a delay timer on your wash programme. The delay timer will start then start the wash programme after the time that you set has expired. For example the time is now 4pm and you set a 2 hour delay timer, your washing programme will start at 6pm.

- Press the **Delay** button to cycle through the delay times starting from 1 hour up to 23 hours.

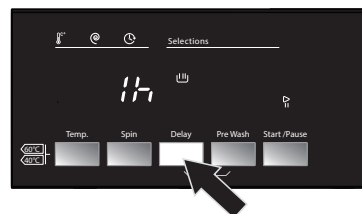

how to set the child lock

The Child Lock prevents children from stopping programmes accidentally. It only locks the control buttons not the **Programme Dial**.

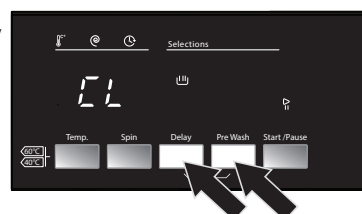

Switch the washing machine on.

1. When the washing machine is operating, press and hold **Easy Delay Timer** and **Prewash** button for 3 seconds. The letters 'CL' will be displayed for a few seconds showing the child lock is active. If any button is pressed or the Programme Dial is turned the letters 'CL' will flash in the display. Press the buttons in the same way to unlock.



The child lock will switch off automatically at the end of the wash programme.

selecting a prewash

On some programmes you can select to add a Prewash to the programme. Press the Prewash button to add a prewash. The  symbol will appear in the display. If the  symbol flashes then disappears from the display its not possible to add a Prewash to the selected wash programme.



Finishing programme

- Your machine will stop by itself as soon as the programme you have selected finishes.
- The door lock will release and the End show in the display.
- Turn the **Programme Dial** back to OFF.

removing laundry

1. Open the washing machine door and remove your laundry.
2. Remove any foreign objects to avoid risk of rusting.
3. Leave the door and detergent drawer open so that residual water can evaporate.
4. If you have finished using the washing machine, turn off the water and mains supply.

maintenance - cleaning the washing machine



Always unplug the washing machine before cleaning.

cleaning the drum

Any rust left inside the drum by metal articles must be removed immediately with chlorine-free detergent.

Never use steel wool.



Don't put laundry in the washing machine during the drum cleaning.

cleaning the exterior of your washing machine

- Clean the outside of your washing machine with a soft cloth and mild detergent such as kitchen detergent.
- Don't splash water over the washing machine.
- Do not use cream cleansers, thinners or products containing alcohol or kerosene.

cleaning the detergent drawer and siphon plug

1. Remove the detergent drawer by pulling and pressing gently on the rear centre part of the softener compartment.
2. Wash out old detergent from the drawer with water. (Use a cloth to clean the washing machine.) Residue detergent soon builds up if you don't clean the drawer regularly, and can develop mould.
3. Return drawer to original position.

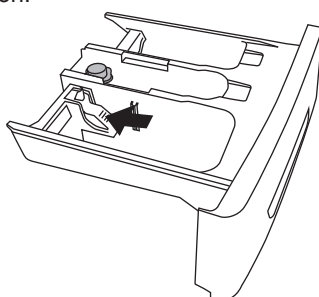
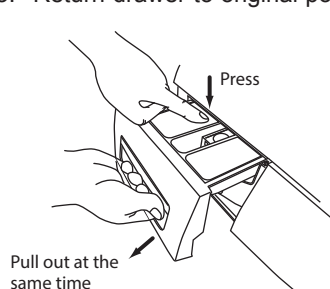

4. Disassemble the detergent drawer. Remove the siphon plug and clean the any residual softener thoroughly. Replace the cleaned siphon plug and check that it is fitted properly.

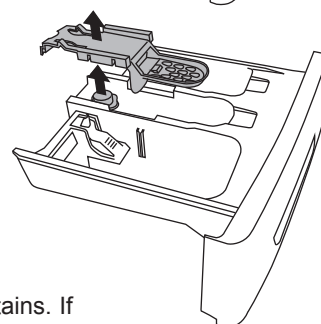

cleaning the door seal and window

- Wipe the window and seal after each wash to remove lint and stains. If lint builds up, it can cause leaks.
- Remove any coins, buttons and other objects from the door seal after each wash.

* All images are for indication only; please refer to your individual unit for actual item.

cleaning the drain filter



Be careful not to burn yourself while cleaning the drain filter. Water draining from the filter compartment may be hot after a high temperature wash.

Before cleaning the drain filter, first start the spin programme, then switch off and unplug the washing machine.

1. Gently Open the Service Flap. Place a suitable container under the service flap to catch the water.

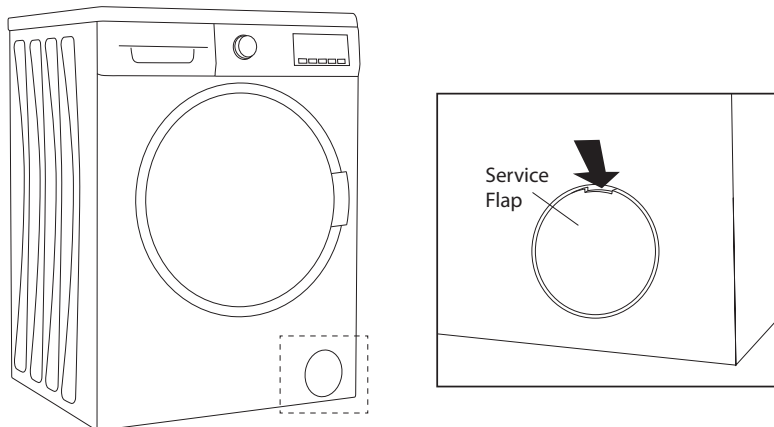

2. Carefully loosen the drain filter. Turn anti-clockwise until the water gently begins to run out, this is normal.
3. Remove the filter once the water has stopped.
4. Remove any lint and debris before carefully replacing the filter.

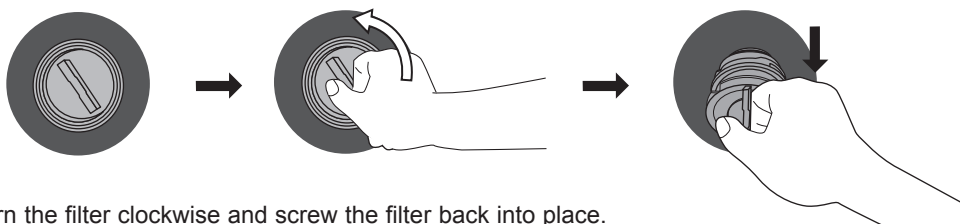

5. Turn the filter clockwise and screw the filter back into place.
6. Close the service flap.

cleaning the filter net of the water supply hose

1. Turn the water supply off at the tap.
2. Turn the power off. Remove the water supply hose from the tap.
3. Manually remove the filter net located on the tap side of the water supply hose and clean using a small brush (e.g. a toothbrush).
4. Return the filter net to its original position.
5. Re-connect the water supply hose to the tap and turn the tap back on, checking for leaks. Then turn the power back on.

troubleshooting

Problem	Possible Causes	Remedy
Your machine does not start.	It is not plugged in.	Plug it in and switch on at the mains.
	Fuse blown.	Replace the fuse.
	Power cut.	Check mains power.
	Start/Pause button not pressed.	Press on Start/Pause button.
	The door is not closed properly.	Close the door.
	Programme dial is in the 'stop' position.	Turn the programme dial to the desired position.
Your machine does not intake water.	Water tap is turned off.	Turn your water tap on.
	Water inlet hose may be twisted.	Check water inlet hose and untwist.
	Water inlet hose clogged.	Clean water inlet hose filters.
	Valve inlet filter clogged.	Clean the valve inlet filters.
	The door is not closed properly.	Close the door.
Your machine does not discharge water.	Discharging hose is clogged or twisted.	Check the discharging hose, then either clean or untwist it.
	Pump filter clogged.	Clean the pump filter.
Your machine vibrates.	The machine is not level.	Adjust the feet and level the machine.
	The transit bolts are still in place.	Remove the transit bolts.
	You have only loaded a very small load so the drum is unbalanced.	Add more laundry.
	Your machine is overloaded or not loaded correctly.	Remove some laundry and load the drum correctly.
Excessive foam is formed in the detergent drawer.	Excessive amount of detergent used.	Press on Start/Pause button. To eliminate foam formation, mix a spoon of softener with half a litre of water, and pour the mixture in the detergent drawer. After 5-10 minutes, press on Start/Pause button again. In your next washing operation, adjust the detergent dose accordingly.
	Wrong detergent used.	Use detergents produced only for automatic washing machines in your machine.

Problem	Possible Causes	Remedy
Unsatisfactory washing result.	Your laundry is too soiled for the wash programme you have chosen.	Choose a programme that is suitable.
	Amount of detergent used is insufficient.	Adjust the amount of detergent based on the amount the laundry is soiled. Check your detergent instructions, make sure you are adding the correct amount for the weight of your load.
	You're machine is overloaded.	Load the correct weight of laundry. Check the programme table. Not all programmes allow 8kgs of laundry.
	The water in your area may be very hard.	Check the detergent guidelines, you may need to increase the amount of detergent used.
	You may not have loaded your laundry evenly.	Load your laundry correctly.
You can't see water in the drum during washing.	No fault. Water is in the unseen part of the drum.	-
The laundry has detergent residue after washing.	Non-dissolving particles of some detergents may stick to your laundry and show as white spots.	Perform an extra rinse by setting your machine to "Rinse" programme, or clean the spots using a brush after your laundry is dry.
Grey spots appear on the laundry.	The reason for such spots may be oil, cream or ointment.	Apply the maximum amount of detergent instructed by the detergent manufacturer in the next washing operation.
Spinning operation is not performed or runs late.	No fault. Unbalanced load control system has been activated.	Unbalanced load control system will try to spread your laundry by tumbling for a while. Spinning operation will begin after your laundry is spread. Place the laundry in the machine in a balanced fashion the next time.

error codes

Your washing machine has some built-in error codes. If it stops working properly the table below shows you which lights will be illuminated and what the possible fault is.

Problem	Possible Fault	What to do
E01	The door of your machine is not shut properly.	Shut the door properly until you hear a click. If your machine persists to indicate the fault, turn off your machine, unplug it and contact the nearest authorised service agent immediately.
E02	The water pressure or the water level inside the machine is low.	Check the tap is fully turned on. Mains water may be cut-off. If the problem still continues, your machine will stop after a while automatically. Unplug the machine, turn off your tap and contact the nearest authorised service agent.
E03	The pump is faulty or pump filter is clogged or electrical connection of the pump is faulty.	Clean the pump filter. If the problem persists, contact the nearest authorised service.
E04	Your machine has excessive amount of water.	Your machine should automatically pump excess water out, if it doesn't contact the nearest authorised service.

product fiche

Brand: Kenwood

Model: K814WM18 / K814WMT18

Rated capacity: 8 kg

Energy efficiency class: A+++

Energy consumption is 194 kwh per year based on 220 standard washing cycles for cotton programmes set at 60° C and 40° C, with full and partial loads, and the consumption of low-power modes.

Actual energy consumption will depend on how the appliance is used.

Energy consumption of:

- Standard Cotton programme, 60° C, with a full load: 1.10 kwh
- Standard Cotton programme, 60° C, with a partial load: 0.70 kwh
- Standard Cotton programme, 40° C, with a partial load: 0.63 kwh

Power consumption when appliance is:

- Turned off: 0.5 W
- Left on: 1.00 W

Water consumption is 10224 litres per year based on 220 standard washing cycles for cotton programmes set at 60° C and 40° C, with full and partial loads.

Actual water consumption will depend on how the appliance is used.

Spin-drying efficiency class is "B", on a scale of A (most efficient) to G (least efficient).

Maximum spin speed: 1400 rpm

Remaining moisture content: 53%

Standard washing cycle programmes are the Standard 60° C Cotton Programme and the Standard 40° C Cotton Programme. These cycles are suitable for cleaning naturally-soiled laundry and are the most efficient washing cycles in terms of combined energy and water consumption.

Time required:

- Standard Cotton programme, 60° C, with a full load: 240 mins
- Standard Cotton programme, 60° C, with a partial load: 185 mins
- Standard Cotton programme, 40° C: 180 mins

Airborne acoustical noise (spinning): 78 dB

Airborne acoustical noise (standard 60° C): 58 dB

energy label

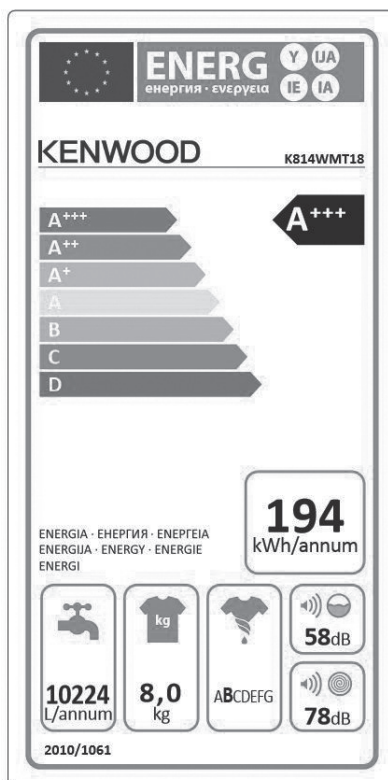
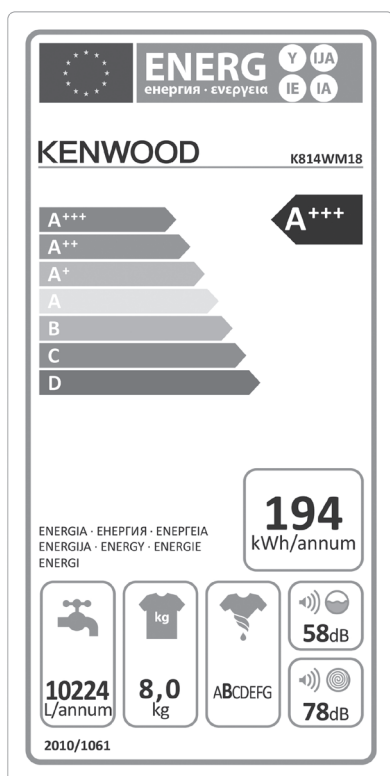

specifications

model	K814WM18 / K814WMT18
rated voltage	220-240 V~ 50Hz
maximum current	10 A
rated power input	2200 W
dimension (H x W x D)	845 mm x 597 mm x 557 mm
net weight	70 kg
rated capacity	8 kg
maximum spin speed	1400 rpm
inlet water pressure	Minimum 0.1 MPa; Maximum 1.0 MPa

Features and specifications are subject to change without prior notice.

Need Help with your product?

Your product is supported by Team Knowhow

under a Trademark Licence from Fisher & Paykel Appliances Italy SpA.

For help or spare parts please call us on:

0344 561 1234



The symbol on the product or its packaging indicates that this product must not be disposed of with your other household waste. Instead, it is your responsibility to dispose of your waste equipment by handing it over to a designated collection point for the recycling of waste electrical and electronic equipment. The separate collection and recycling of your waste equipment at the time of disposal will help conserve natural resources and ensure that it is recycled in a manner that protects human health and the environment.

For more information about where you can drop off your waste for recycling, please contact your local authority, or where you purchased your product.

DSG Retail Ltd. (co. no. 504877)
1 Portal Way, London, W3 6RS, UK

Manufactured for DSG Retail Limited under Licence from Fisher & Paykel Appliances Italy SpA.
DSG Retail Limited is responsible for after sales service.

IB-K814WM18/T18-180620V1