



## Wireless Keyboard

Quick Start Guide  
K312



### Thank you

for purchasing your new Advent Wireless Keyboard.

We recommend that you spend some time reading this instruction manual in order to fully understand all the operational features offered.

Read all the safety instructions carefully before use and keep this instruction manual for future reference.

### > UNPACKING

Remove all packaging from the unit. Retain the packaging. If you dispose of it, please do so according to local regulations. The following items are included:



Keyboard



AAA size batteries × 2  
(P.N.: AAABTY)



RF Receiver  
(P.N.: MRN)



Quick Start Guide  
(PN.: K312-001)

If items are missing or damaged, please contact Partmaster (UK only). Tel: 0844 800 3456 for assistance.

### > SYSTEM REQUIREMENTS

Operating Systems: Microsoft® Window®XP/Vista™ & Windows®7

Hardware: 1 available USB port

### > PRODUCT OVERVIEW



ON/OFF Switch

Connect button

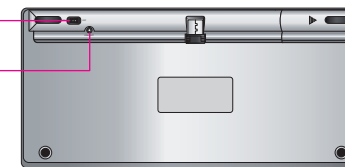

### > INSTALLING THE BATTERIES

1. Remove the battery cover.
2. Insert the batteries.
3. Close the battery cover.



AAA size batteries × 2

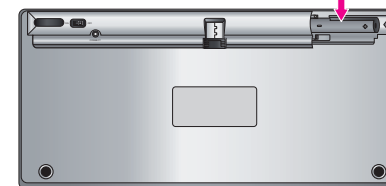

Please ensure the batteries' polarities (+ / -) match the battery compartment's polarities.

### > CONNECT THE USB NANO RECEIVER

1. Switch on your computer.
2. Slide the power switch of the keyboard to the **ON** position.
3. Insert the RF receiver into a free USB slot.
4. The keyboard should connect automatically.

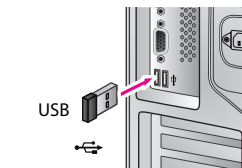

### > ACTIVATING THE KEYBOARD

If the keyboard does not respond, perform the following:

1. Remove the RF receiver.
2. Turn over the keyboard without pressing any key. Check the power switch is in the **ON** position.
3. Re-insert the RF receiver into the USB slot.

ON/OFF Switch

Connect Button

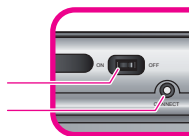

Keyboard

4. Then press any key. The keyboard should now be activated and ready for use.

## > FUNCTION KEYS

To use these function keys, ensure that **numlock** is off. Then first press and hold the **fn** button then the desired key.

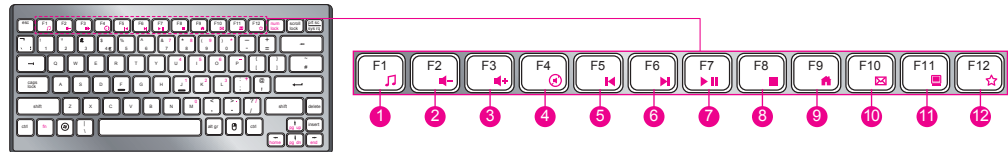

1	Media	Starts the media player.
2	Volume Down	Decreases audio volume.
3	Volume Up	Increases audio volume.
4	Mute	Turns off the audio output.
5	Prev	Goes to previous track.
6	Next	Goes to next track.
7	Play / Pause	Play / Pauses media content.
8	Stop	Stops playing media content.
9	Homepage	Opens your default web browser to the web page set to display on opening.
10	E-mail	Launches the default e-mail application.
11	My Computer	Opens a new window for "My Computer".
12	My Favorite	Opens the browser's favourites folder or bookmarks folder.

## > HINTS AND TIPS

### Number pad:

To access the embedded number pad, press **numlock**. To return to the full normal keyboard, press **numlock** again.

### Keyboard not working:

1. Have the batteries been inserted incorrectly or are they spent?  
Check the polarity (+/-) or exchange them for new ones as necessary.
2. Make sure the USB Receiver is plugged into a USB port and the computer is on.
3. Remove metallic objects between the keyboard and the USB Nano receiver.
4. If the Nano receiver is plugged into a USB hub, try plugging it directly into the computer's USB port.
5. Move the keyboard closer to the receiver.
6. Turn off the keyboard and remove the USB receiver. Plug in the USB receiver and turn the keyboard back on, press and hold the Connect button.
7. Restart the computer.

## > SAFETY WARNINGS

- Don't disassemble the keyboard or remove any parts.
- Don't immerse the keyboard in water or any liquid.
- Don't use the keyboard close to heat sources or expose to high temperatures.
- Don't use the keyboard where strong electromagnetic waves are present. Strong electromagnetic waves will cause damage to the keyboard.
- Keep the keyboard away from direct sunlight, moisture, dirt or abrasive chemical products (cleaning products etc).

### Wireless Devices:

- Before boarding any aircraft or packing a wireless device in luggage that will be checked in, remove the batteries from the wireless device.
- Wireless devices can transmit radio frequency (RF) energy, whenever batteries are installed and the wireless device is turned on.

### Battery-Powered Devices:

- Improper use of batteries may result in battery fluid leakage, overheating, or explosion. Released battery fluid is corrosive and may be toxic. It can cause skin and eye burns, and is harmful if swallowed.

### To reduce the risk of injury :

- Keep batteries out of the reach of children.
- Do not heat, open, puncture, mutilate, or dispose of batteries in fire.
- Do not mix new and old batteries or batteries of different types.
- Do not allow metal objects to touch the battery terminals on the device; they can become hot and cause burns.
- Always remove old, weak, or worn out batteries promptly and recycle or dispose of them in accordance with Local and National Disposal Regulations.
- If a battery leaks, remove all batteries, taking care to keep the leaked fluid from touching your skin or clothes. If fluid from the battery comes into contact with skin or clothes, flush skin with water immediately. Before inserting new batteries, thoroughly clean the battery compartment with a damp paper towel, or follow the battery manufacturer's recommendations to clean.

Features and specifications are subject to change without prior notice.  
Windows is a registered trademark of Microsoft Corporation in the United States and other countries.

DSG International Sourcing declares that the wireless keyboard complies with the essential requirements and other relevant provisions of Directive 1999/5/EC.

### Notes for battery disposal:

The batteries used with this product contain chemicals that are harmful to the environment. To preserve our environment, disposal of used batteries according to your local laws or regulations. Do not dispose of batteries with the normal household waste.  
For more information, please contact the local authority or your retailer where you purchased the product.



Visit [Partmaster.co.uk](http://Partmaster.co.uk) today for the easiest way to buy electrical spares and accessories. With over 1 million spares and accessories available we can deliver direct to your door the very next day. Visit [www.partmaster.co.uk](http://www.partmaster.co.uk) or call 0844 800 3456 (UK customers only). Calls charged at National Rate.



This symbol on the product or in the instructions means that your electrical and electronic equipment should be disposed at the end of its life separately from your household waste. There are separate collection systems for recycling in the EU.  
For more information, please contact the local authority or your retailer where you purchased the product.

DSG Retail Ltd • Maylands Avenue • Hemel Hempstead • Herts • HP2 7TG • England

(P.N.: K312-001)